

# 5PzS 625

(2V625Ah/5HR)



## Specification

Voltage Per Unit	2V(single cell)
Capacity	625Ah@5hr-rate to 1.70V per cell @25°C
Weight	Approx. without electrolyte 25.9 Kg Approx. including electrolyte 33.4 Kg
High Rate Discharge Current	625 A
Operating Temperature Range	Discharge: -40°C~60°C Charge: -20°C~50°C Storage: -40°C~60°C
Optimal Operating Temperature Range	25°C ± 5°C
Maximum Charging Current	93.8 A
Cycle charged	2.65 to 2.85 VDC/unit Average at 25°C
Self Discharge	Self-discharge ratio less than 5% per month at 25°C. Please charge batteries before using.
Terminal	D2(M10 Copper Terminals) & D4(Lead Terminals)
Dimensions (L×W×H×TH)	101mm×198mm×570mm×600mm(Total High)

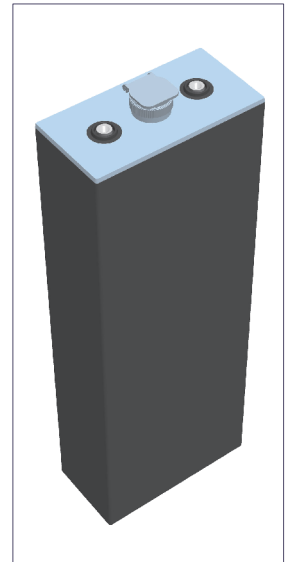

### Constant Current Discharge Characteristics : A(25 °C)

F.V/Time	30MIN	1HR	2HR	3HR	4HR	5HR	6HR	8HR	10HR
1.60V	592.1	414.6	240.2	179.9	146.7	131.6	114.1	88.8	73.4
1.65V	578.5	405.1	234.7	175.8	143.4	128.6	111.5	86.8	71.7
1.70V	562.3	393.8	228.1	170.8	139.4	125.0	108.3	84.4	69.7
1.75V	540.9	378.6	219.4	164.3	134.0	120.2	104.2	81.1	67.0
1.80V	516.3	361.6	209.5	156.9	128.0	114.8	99.5	77.5	64.0
1.85V	489.1	342.6	198.5	148.7	121.3	108.8	94.3	73.4	60.6

### Constant Power Discharge Characteristics : W(25 °C)

F.V/Time	30MIN	1HR	2HR	3HR	4HR	5HR	6HR	8HR	10HR
1.60V	1107.3	798.4	471.8	356.7	291.5	261.7	226.8	176.8	146.1
1.65V	1087.5	781.9	462.1	350.1	285.8	256.6	222.4	173.3	143.3
1.70V	1069.3	761.2	449.8	341.4	278.5	250.0	216.7	168.8	139.4
1.75V	1029.2	732.2	432.7	328.2	267.8	240.4	208.3	162.3	134.0
1.80V	983.6	703.0	415.4	313.5	256.0	229.6	199.0	155.0	128.0
1.85V	937.3	671.2	396.6	297.3	242.6	217.5	188.5	146.8	121.3

### Life characteristics of cyclic use

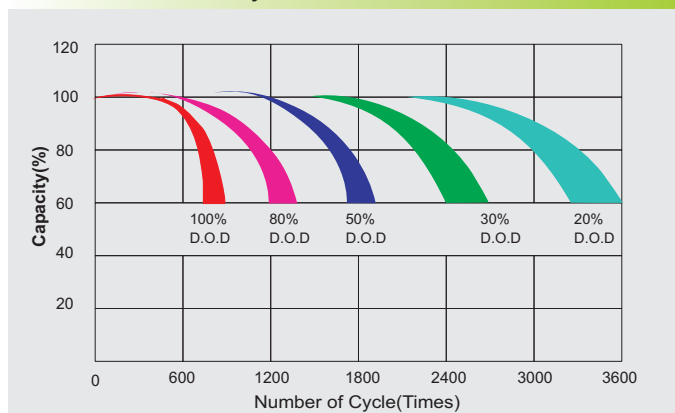

### Charge characteristic Curve for cycle use

