

5PzS 450

(2V450Ah/5HR)



Specification

Voltage Per Unit	2V(single cell)
Capacity	450Ah@5hr-rate to 1.70V per cell @25°C
Weight	Approx. without electrolyte 20.8 Kg Approx. including electrolyte 26.2 Kg
High Rate Discharge Current	450 A
Operating Temperature Range	Discharge: -40°C~60°C Charge: -20°C~50°C Storage: -40°C~60°C
Optimal Operating Temperature Range	25°C ± 5°C
Maximum Charging Current	67.5 A
Cycle charged	2.65 to 2.85 VDC/unit Average at 25°C
Self Discharge	Self-discharge ratio less than 5% per month at 25°C. Please charge batteries before using.
Terminal	D2(M10 Copper Terminals) & D4(Lead Terminals)
Dimensions (L×W×H×TH)	101mm×198mm×475mm×505mm(Total High)

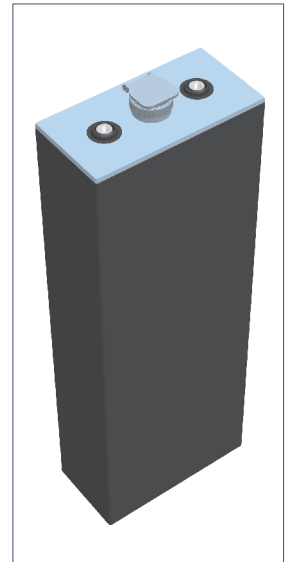

Constant Current Discharge Characteristics : A(25 °C)

F.V/Time	30MIN	1HR	2HR	3HR	4HR	5HR	6HR	8HR	10HR
1.60V	426.3	298.5	172.9	129.5	105.7	94.8	82.1	64.0	52.8
1.65V	416.5	291.7	169.0	126.5	103.2	92.6	80.3	62.5	51.6
1.70V	404.9	283.5	164.3	123.0	100.4	90.0	78.0	60.8	50.2
1.75V	389.4	272.6	157.9	118.3	96.5	86.5	75.0	58.4	48.2
1.80V	371.7	260.3	150.8	112.9	92.1	82.6	71.6	55.8	46.1
1.85V	352.2	246.7	142.9	107.0	87.3	78.3	67.9	52.9	43.7

Constant Power Discharge Characteristics : W(25 °C)

F.V/Time	30MIN	1HR	2HR	3HR	4HR	5HR	6HR	8HR	10HR
1.60V	797.3	574.9	339.7	256.8	209.9	188.4	163.3	127.3	105.2
1.65V	783.0	563.0	332.7	252.0	205.8	184.7	160.1	124.8	103.2
1.70V	769.9	548.1	323.9	245.8	200.5	180.0	156.0	121.5	100.4
1.75V	741.0	527.2	311.5	236.3	192.8	173.1	150.0	116.8	96.5
1.80V	708.2	506.1	299.1	225.7	184.3	165.3	143.3	111.6	92.1
1.85V	674.9	483.3	285.6	214.1	174.6	156.6	135.8	105.7	87.3

Life characteristics of cyclic use

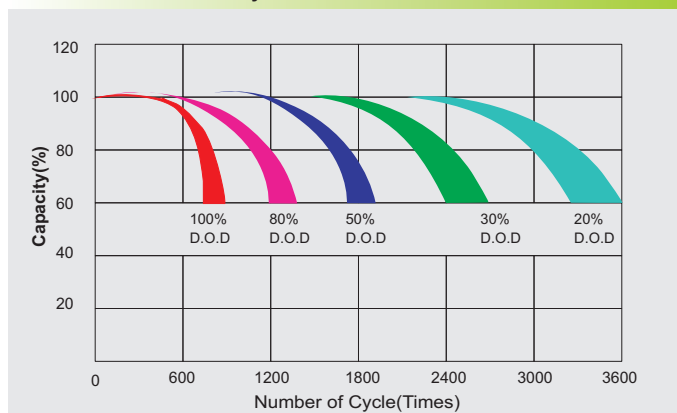

Charge characteristic Curve for cycle use

