

# 3PzS 465

(2V465Ah/5HR)



## Specification

Voltage Per Unit	2V(single cell)
Capacity	465Ah@5hr-rate to 1.70V per cell @25°C
Weight	Approx. without electrolyte 21.3 Kg Approx. including electrolyte 27.0 Kg
High Rate Discharge Current	465 A
Operating Temperature Range	Discharge: -40°C~60°C Charge: -20°C~50°C Storage: -40°C~60°C
Optimal Operating Temperature Range	25°C ± 5°C
Maximum Charging Current	69.8 A
Cycle charged	2.65 to 2.85 VDC/unit Average at 25°C
Self Discharge	Self-discharge ratio less than 5% per month at 25°C. Please charge batteries before using.
Terminal	D2(M10 Copper Terminals) & D4(Lead Terminals)
Dimensions (L×W×H×TH)	65mm×198mm×720mm×750mm(Total High)

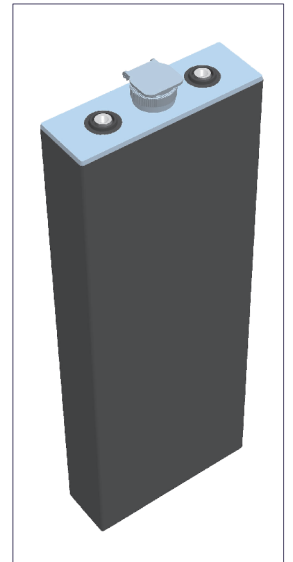

### Constant Current Discharge Characteristics : A(25 °C)

F.V/Time	30MIN	1HR	2HR	3HR	4HR	5HR	6HR	8HR	10HR
1.60V	440.5	308.4	178.7	133.8	109.2	97.9	84.9	66.1	54.6
1.65V	430.4	301.4	174.6	130.8	106.7	95.7	82.9	64.6	53.3
1.70V	418.3	293.0	169.7	127.1	103.7	93.0	80.6	62.8	51.8
1.75V	402.4	281.7	163.2	122.2	99.7	89.4	77.5	60.4	49.9
1.80V	384.1	269.0	155.9	116.7	95.2	85.4	74.0	57.6	47.6
1.85V	363.9	254.9	147.7	110.6	90.2	80.9	70.1	54.6	45.1

### Constant Power Discharge Characteristics : W(25 °C)

F.V/Time	30MIN	1HR	2HR	3HR	4HR	5HR	6HR	8HR	10HR
1.60V	823.8	594.0	351.0	265.4	216.9	194.7	168.8	131.5	108.7
1.65V	809.1	581.8	343.8	260.4	212.7	190.9	165.5	129.0	106.6
1.70V	795.5	566.3	334.7	254.0	207.2	186.0	161.2	125.6	103.7
1.75V	765.7	544.8	321.9	244.2	199.2	178.8	155.0	120.7	99.7
1.80V	731.8	523.0	309.1	233.2	190.4	170.8	148.0	115.3	95.2
1.85V	697.4	499.4	295.1	221.2	180.5	161.9	140.3	109.3	90.2

### Life characteristics of cyclic use

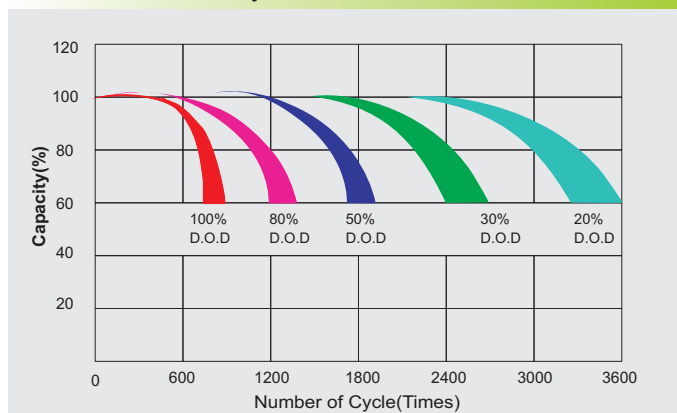

### Charge characteristic Curve for cycle use

