

3PzS 375

(2V375Ah/5HR)



Specification

Voltage Per Unit	2V(single cell)
Capacity	375Ah@5hr-rate to 1.70V per cell @25°C
Weight	Approx. without electrolyte 16.7 Kg Approx. including electrolyte 21.2 Kg
High Rate Discharge Current	375 A
Operating Temperature Range	Discharge: -40°C~60°C Charge: -20°C~50°C Storage: -40°C~60°C
Optimal Operating Temperature Range	25°C ± 5°C
Maximum Charging Current	56.3 A
Cycle charged	2.65 to 2.85 VDC/unit Average at 25°C
Self Discharge	Self-discharge ratio less than 5% per month at 25°C. Please charge batteries before using.
Terminal	D2(M10 Copper Terminals) & D4(Lead Terminals)
Dimensions (L×W×H×TH)	65mm×198mm×570mm×600mm(Total High)

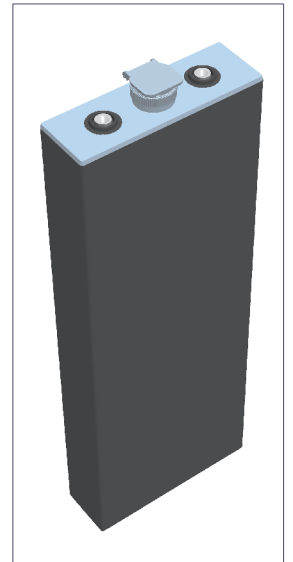

Constant Current Discharge Characteristics : A(25 °C)

F.V/Time	30MIN	1HR	2HR	3HR	4HR	5HR	6HR	8HR	10HR
1.60V	355.2	248.7	144.1	107.9	88.0	79.0	68.4	53.3	44.0
1.65V	347.1	243.1	140.8	105.5	86.0	77.2	66.9	52.1	43.0
1.70V	337.4	236.3	136.9	102.5	83.6	75.0	65.0	50.6	41.8
1.75V	324.5	227.2	131.6	98.6	80.4	72.1	62.5	48.7	40.2
1.80V	309.8	216.9	125.7	94.1	76.8	68.9	59.7	46.5	38.4
1.85V	293.5	205.6	119.1	89.2	72.8	65.3	56.6	44.1	36.4

Constant Power Discharge Characteristics : W(25 °C)

F.V/Time	30MIN	1HR	2HR	3HR	4HR	5HR	6HR	8HR	10HR
1.60V	664.4	479.1	283.1	214.0	174.9	157.0	136.1	106.1	87.7
1.65V	652.5	469.2	277.3	210.0	171.5	153.9	133.4	104.0	86.0
1.70V	641.6	456.7	269.9	204.8	167.1	150.0	130.0	101.3	83.6
1.75V	617.5	439.3	259.6	196.9	160.7	144.2	125.0	97.4	80.4
1.80V	590.1	421.8	249.3	188.1	153.6	137.7	119.4	93.0	76.8
1.85V	562.4	402.7	238.0	178.4	145.5	130.5	113.1	88.1	72.8

Life characteristics of cyclic use

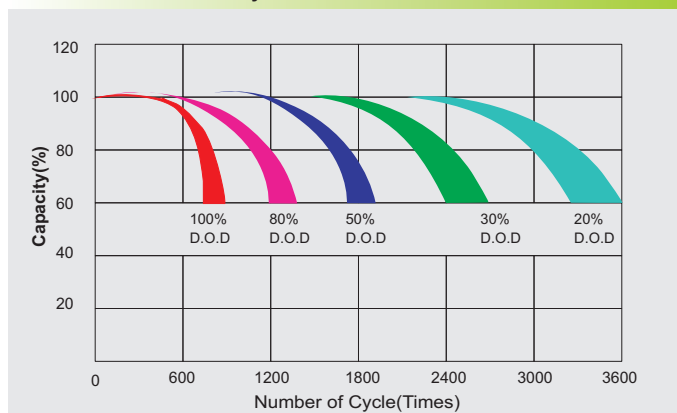

Charge characteristic Curve for cycle use

