

# 3PzS 345

(2V345Ah/5HR)



## Specification

Voltage Per Unit	2V(single cell)
Capacity	345Ah@5hr-rate to 1.70V per cell @25°C
Weight	Approx. without electrolyte 16.1 Kg Approx. including electrolyte 20.3 Kg
High Rate Discharge Current	345 A
Operating Temperature Range	Discharge: -40°C~60°C Charge: -20°C~50°C Storage: -40°C~60°C
Optimal Operating Temperature Range	25°C ± 5°C
Maximum Charging Current	51.8 A
Cycle charged	2.65 to 2.85 VDC/unit Average at 25°C
Self Discharge	Self-discharge ratio less than 5% per month at 25°C. Please charge batteries before using.
Terminal	D2(M10 Copper Terminals) & D4(Lead Terminals)
Dimensions (L×W×H×TH)	65mm×198mm×545mm×575mm(Total High)

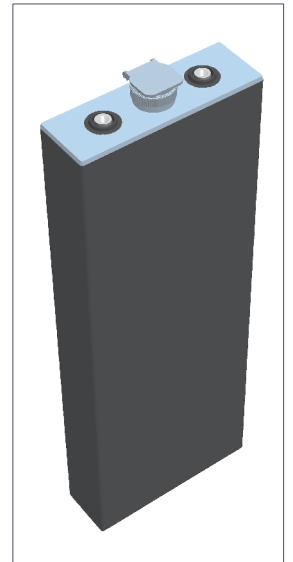

## Constant Current Discharge Characteristics : A(25 °C)

F.V/Time	30MIN	1HR	2HR	3HR	4HR	5HR	6HR	8HR	10HR
1.60V	326.8	228.8	132.6	99.3	81.0	72.6	63.0	49.0	40.5
1.65V	319.3	223.6	129.6	97.0	79.2	71.0	61.5	47.9	39.6
1.70V	310.4	217.4	125.9	94.3	76.9	69.0	59.8	46.6	38.5
1.75V	298.6	209.0	121.1	90.7	74.0	66.3	57.5	44.8	37.0
1.80V	285.0	199.6	115.6	86.6	70.6	63.4	54.9	42.8	35.3
1.85V	270.0	189.1	109.6	82.1	66.9	60.0	52.0	40.5	33.5

## Constant Power Discharge Characteristics : W(25 °C)

F.V/Time	30MIN	1HR	2HR	3HR	4HR	5HR	6HR	8HR	10HR
1.60V	611.2	440.7	260.4	196.9	160.9	144.4	125.2	97.6	80.7
1.65V	600.3	431.6	255.1	193.2	157.8	141.6	122.8	95.7	79.1
1.70V	590.2	420.2	248.3	188.4	153.7	138.0	119.6	93.2	76.9
1.75V	568.1	404.2	238.8	181.2	147.8	132.7	115.0	89.6	74.0
1.80V	542.9	388.0	229.3	173.0	141.3	126.7	109.8	85.5	70.6
1.85V	517.4	370.5	218.9	164.1	133.9	120.1	104.1	81.1	66.9

## Life characteristics of cyclic use

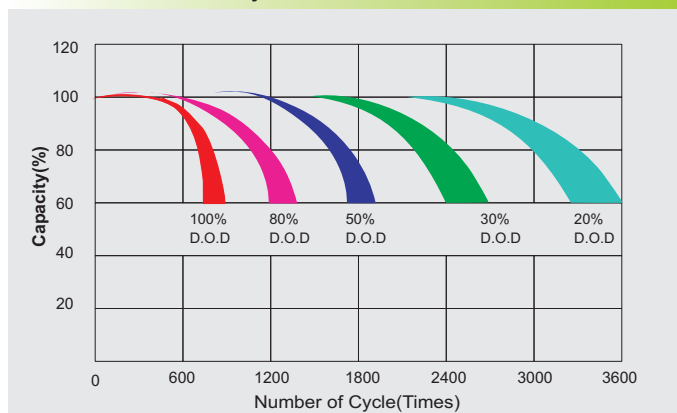

## Charge characteristic Curve for cycle use

