

3PzS 240

(2V240Ah/5HR)



Specification

Voltage Per Unit	2V(single cell)
Capacity	240Ah@5hr-rate to 1.70V per cell @25°C
Weight	Approx. without electrolyte 11.8 Kg Approx. including electrolyte 14.7 Kg
High Rate Discharge Current	240 A
Operating Temperature Range	Discharge: -40°C~60°C Charge: -20°C~50°C Storage: -40°C~60°C
Optimal Operating Temperature Range	25°C ± 5°C
Maximum Charging Current	36.0 A
Cycle charged	2.65 to 2.85 VDC/unit Average at 25°C
Self Discharge	Self-discharge ratio less than 5% per month at 25°C. Please charge batteries before using.
Terminal	D2(M10 Copper Terminals) & D4(Lead Terminals)
Dimensions (L×W×H×TH)	65mm×198mm×405mm×435mm(Total High)

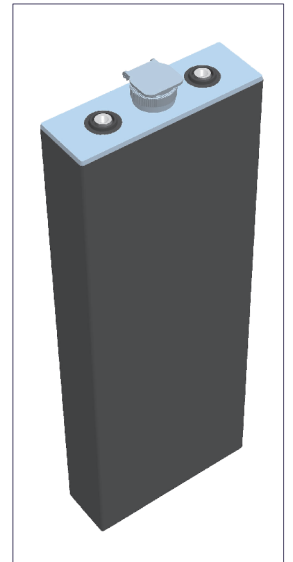

Constant Current Discharge Characteristics : A(25°C)

F.V/Time	30MIN	1HR	2HR	3HR	4HR	5HR	6HR	8HR	10HR
1.60V	227.4	159.2	92.2	69.1	56.4	50.5	43.8	34.1	28.2
1.65V	222.1	155.6	90.1	67.5	55.1	49.4	42.8	33.3	27.5
1.70V	215.9	151.2	87.6	65.6	53.5	48.0	41.6	32.4	26.8
1.75V	207.7	145.4	84.2	63.1	51.5	46.2	40.0	31.2	25.7
1.80V	198.3	138.8	80.4	60.2	49.1	44.1	38.2	29.8	24.6
1.85V	187.8	131.6	76.2	57.1	46.6	41.8	36.2	28.2	23.3

Constant Power Discharge Characteristics : W(25°C)

F.V/Time	30MIN	1HR	2HR	3HR	4HR	5HR	6HR	8HR	10HR
1.60V	425.2	306.6	181.2	137.0	112.0	100.5	87.1	67.9	56.1
1.65V	417.6	300.3	177.4	134.4	109.8	98.5	85.4	66.6	55.0
1.70V	410.6	292.3	172.7	131.1	106.9	96.0	83.2	64.8	53.5
1.75V	395.2	281.2	166.2	126.0	102.8	92.3	80.0	62.3	51.5
1.80V	377.7	269.9	159.5	120.4	98.3	88.2	76.4	59.5	49.1
1.85V	359.9	257.7	152.3	114.2	93.1	83.5	72.4	56.4	46.6

Life characteristics of cyclic use

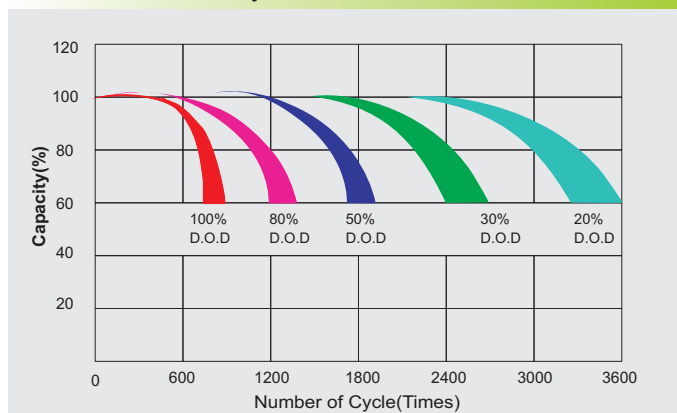

Charge characteristic Curve for cycle use

