

3PzB 195

(2V195Ah/5HR)



Specification

Voltage Per Unit	2V(single cell)
Capacity	195Ah@5hr-rate to 1.70V per cell @25°C
Weight	Approx. without electrolyte 10.1 Kg Approx. including electrolyte 12.4 Kg
High Rate Discharge Current	195 A
Operating Temperature Range	Discharge: -40°C~60°C Charge: -20°C~50°C Storage: -40°C~60°C
Optimal Operating Temperature Range	25°C±5°C
Maximum Charging Current	29.3 A
Cycle charged	2.65 to 2.85 VDC/unit Average at 25°C
Self Discharge	Self-discharge ratio less than 5% per month at 25°C. Please charge batteries before using.
Terminal	D2(M10 Copper Terminals) & D4(Lead Terminals)
Dimensions (L×W×H×TH)	61mm×158mm×454mm×484mm(Total High)

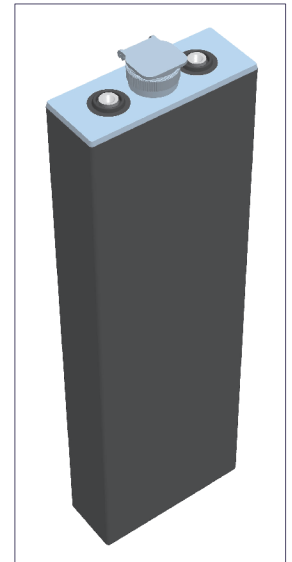

Constant Current Discharge Characteristics : A(25°C)

F.V/Time	30MIN	1HR	2HR	3HR	4HR	5HR	6HR	8HR	10HR
1.60V	184.7	129.3	74.9	56.1	45.8	41.1	35.6	27.7	22.9
1.65V	180.5	126.4	73.2	54.8	44.7	40.1	34.8	27.1	22.4
1.70V	175.4	122.9	71.2	53.3	43.5	39.0	33.8	26.3	21.7
1.75V	168.8	118.1	68.4	51.3	41.8	37.5	32.5	25.3	20.9
1.80V	161.1	112.8	65.4	48.9	39.9	35.8	31.0	24.2	20.0
1.85V	152.6	106.9	61.9	46.4	37.8	33.9	29.4	22.9	18.9

Constant Power Discharge Characteristics : W(25°C)

F.V/Time	30MIN	1HR	2HR	3HR	4HR	5HR	6HR	8HR	10HR
1.60V	345.5	249.1	147.2	111.3	91.0	81.6	70.8	55.2	45.6
1.65V	339.3	244.0	144.2	109.2	89.2	80.0	69.4	54.1	44.7
1.70V	333.6	237.5	140.3	106.5	86.9	78.0	67.6	52.7	43.5
1.75V	321.1	228.5	135.0	102.4	83.6	75.0	65.0	50.6	41.8
1.80V	306.9	219.3	129.6	97.8	79.9	71.6	62.1	48.3	39.9
1.85V	292.4	209.4	123.8	92.8	75.7	67.9	58.8	45.8	37.8

Life characteristics of cyclic use

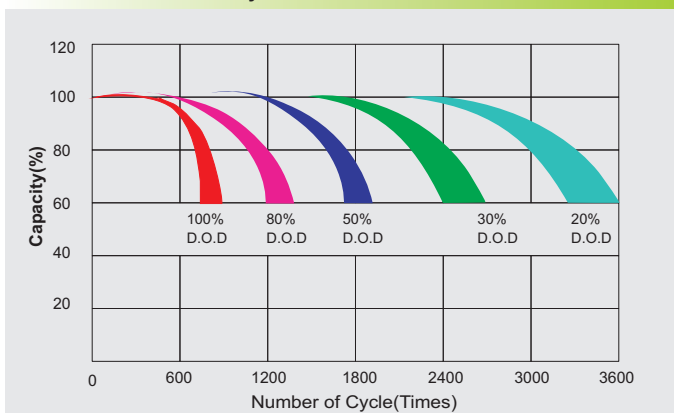

Charge characteristic Curve for standby use

