

12PzB 780

(2V780Ah/5HR)



Specification

Voltage Per Unit	2V(single cell)
Capacity	780Ah@5hr-rate to 1.70V per cell @25°C
Weight	Approx. without electrolyte 34.2 Kg Approx. including electrolyte 43.6 Kg
High Rate Discharge Current	780 A
Operating Temperature Range	Discharge: -40°C~60°C Charge: -20°C~50°C Storage: -40°C~60°C
Optimal Operating Temperature Range	25°C ± 5°C
Maximum Charging Current	117.0 A
Cycle charged	2.65 to 2.85 VDC/unit Average at 25°C
Self Discharge	Self-discharge ratio less than 5% per month at 25°C. Please charge batteries before using.
Terminal	D2(M10 Copper Terminals) & D4(Lead Terminals)
Dimensions (L×W×H×TH)	205mm×158mm×454mm×484mm(Total High)

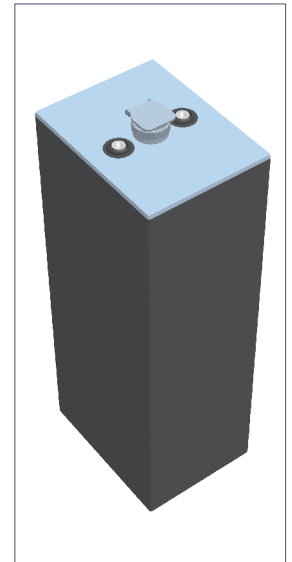

Constant Current Discharge Characteristics : A(25°C)

F.V/Time	30MIN	1HR	2HR	3HR	4HR	5HR	6HR	8HR	10HR
1.60V	738.9	517.4	299.8	224.5	183.1	164.3	142.4	110.9	91.6
1.65V	722.0	505.6	292.9	219.4	179.0	160.5	139.1	108.3	89.5
1.70V	701.7	491.4	284.7	213.2	173.9	156.0	135.2	105.3	87.0
1.75V	675.0	472.5	273.8	205.0	167.3	150.0	130.0	101.3	83.6
1.80V	644.4	451.2	261.4	195.8	159.7	143.3	124.2	96.7	79.9
1.85V	610.4	427.6	247.7	185.5	151.4	135.8	117.7	91.6	75.7

Constant Power Discharge Characteristics : W(25°C)

F.V/Time	30MIN	1HR	2HR	3HR	4HR	5HR	6HR	8HR	10HR
1.60V	1381.9	996.4	588.8	445.2	363.8	326.6	283.1	220.6	182.4
1.65V	1357.1	975.9	576.7	436.9	356.7	320.2	277.6	216.3	178.8
1.70V	1334.4	950.0	561.4	426.0	347.6	312.0	270.4	210.6	173.9
1.75V	1284.4	913.8	540.0	409.7	334.2	300.0	260.0	202.5	167.3
1.80V	1227.5	877.3	518.4	391.2	319.4	286.5	248.3	193.4	159.7
1.85V	1169.8	837.7	495.0	371.1	302.7	271.5	235.3	183.3	151.4

Life characteristics of cyclic use

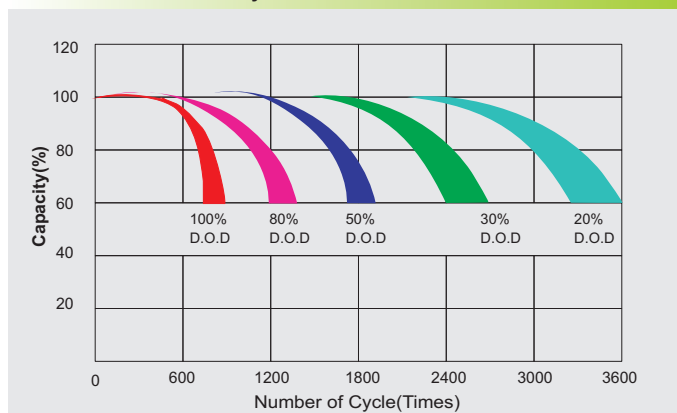

Charge characteristic Curve for cycle use

