

# 12PzB 660

(2V660Ah/5HR)



## Specification

Voltage Per Unit	2V(single cell)
Capacity	660Ah@5hr-rate to 1.70V per cell @25°C
Weight	Approx. without electrolyte 29.9 Kg Approx. including electrolyte 37.8 Kg
High Rate Discharge Current	660 A
Operating Temperature Range	Discharge: -40°C~60°C Charge: -20°C~50°C Storage: -40°C~60°C
Optimal Operating Temperature Range	25°C ± 5°C
Maximum Charging Current	99.0 A
Cycle charged	2.65 to 2.85 VDC/unit Average at 25°C
Self Discharge	Self-discharge ratio less than 5% per month at 25°C. Please charge batteries before using.
Terminal	D2(M10 Copper Terminals) & D4(Lead Terminals)
Dimensions (L×W×H×TH)	205mm×158mm×398mm×428mm(Total High)

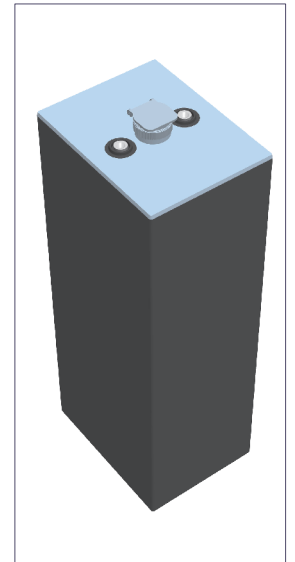

## Constant Current Discharge Characteristics : A(25°C)

F.V/Time	30MIN	1HR	2HR	3HR	4HR	5HR	6HR	8HR	10HR
1.60V	625.2	437.8	253.6	189.9	155.0	139.0	120.5	93.8	77.5
1.65V	610.9	427.8	247.8	185.6	151.4	135.8	117.7	91.7	75.7
1.70V	593.8	415.8	240.9	180.4	147.2	132.0	114.4	89.1	73.6
1.75V	571.2	399.8	231.6	173.5	141.5	126.9	110.0	85.7	70.8
1.80V	545.2	381.8	221.2	165.7	135.2	121.2	105.1	81.8	67.6
1.85V	516.5	361.8	209.6	157.0	128.1	114.9	99.6	77.5	64.0

## Constant Power Discharge Characteristics : W(25°C)

F.V/Time	30MIN	1HR	2HR	3HR	4HR	5HR	6HR	8HR	10HR
1.60V	1169.3	843.1	498.3	376.7	307.9	276.3	239.6	186.7	154.3
1.65V	1148.4	825.7	488.0	369.7	301.8	270.9	234.9	183.0	151.3
1.70V	1129.1	803.8	475.0	360.5	294.1	264.0	228.8	178.2	147.2
1.75V	1086.8	773.2	456.9	346.6	282.8	253.8	220.0	171.3	141.5
1.80V	1038.6	742.3	438.7	331.0	270.3	242.4	210.1	163.6	135.2
1.85V	989.8	708.8	418.9	314.0	256.1	229.7	199.1	155.1	128.1

## Life characteristics of cyclic use

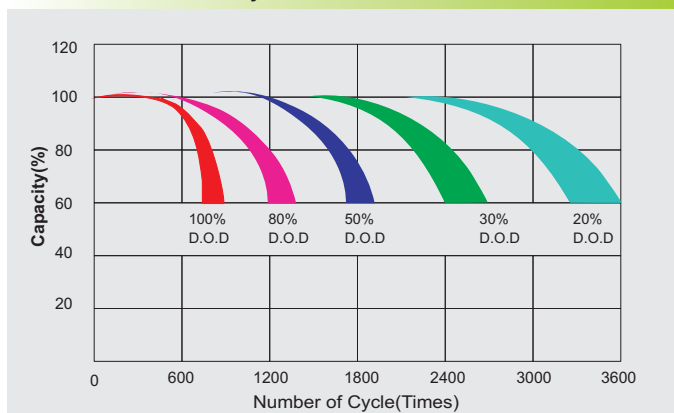

## Charge characteristic Curve for cycle use

