

12PzB 1020

(2V1020Ah/5HR)



Specification

Voltage Per Unit	2V(single cell)
Capacity	1020Ah@5hr-rate to 1.70V per cell @25°C
Weight	Approx. without electrolyte 44.5 Kg Approx. including electrolyte 56.7 Kg
High Rate Discharge Current	1020 A
Operating Temperature Range	Discharge: -40°C~60°C Charge: -20°C~50°C Storage: -40°C~60°C
Optimal Operating Temperature Range	25°C ±5°C
Maximum Charging Current	153.0 A
Cycle charged	2.65 to 2.85 VDC/unit Average at 25°C
Self Discharge	Self-discharge ratio less than 5% per month at 25°C. Please charge batteries before using.
Terminal	D2(M10 Copper Terminals) & D4(Lead Terminals)
Dimensions (L×W×H×TH)	205mm×158mm×567mm×597mm(Total High)

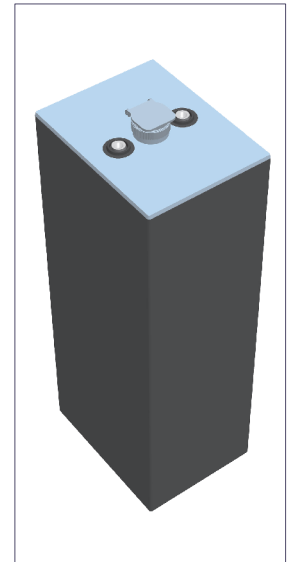

Constant Current Discharge Characteristics : A(25°C)

F.V/Time	30MIN	1HR	2HR	3HR	4HR	5HR	6HR	8HR	10HR
1.60V	966.3	676.6	392.0	293.5	239.5	214.8	186.2	145.0	119.7
1.65V	944.1	661.1	383.0	286.8	234.0	209.9	181.9	141.7	117.0
1.70V	917.7	642.6	372.3	278.8	227.5	204.0	176.8	137.7	113.7
1.75V	882.7	617.9	358.0	268.1	218.7	196.2	170.0	132.4	109.4
1.80V	842.6	590.1	341.9	256.0	208.9	187.3	162.4	126.4	104.4
1.85V	798.3	559.2	324.0	242.6	197.9	177.5	153.9	119.8	99.0

Constant Power Discharge Characteristics : W(25°C)

F.V/Time	30MIN	1HR	2HR	3HR	4HR	5HR	6HR	8HR	10HR
1.60V	1807.1	1303.0	770.0	582.2	475.8	427.1	370.2	288.5	238.5
1.65V	1774.7	1276.1	754.1	571.3	466.5	418.7	363.0	282.9	233.8
1.70V	1745.0	1242.3	734.1	557.1	454.5	408.0	353.6	275.4	227.5
1.75V	1679.6	1195.0	706.2	535.7	437.1	392.3	340.0	264.8	218.7
1.80V	1605.2	1147.2	678.0	511.6	417.7	374.7	324.7	252.9	208.9
1.85V	1529.7	1095.4	647.3	485.2	395.9	355.0	307.7	239.7	197.9

Life characteristics of cyclic use

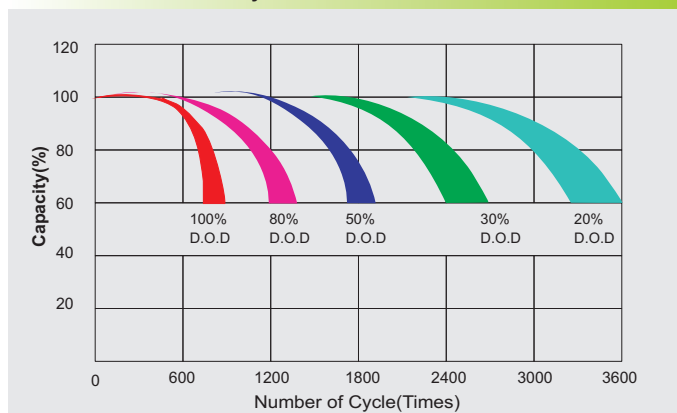

Charge characteristic Curve for cycle use

