

11PzB 825

(2V825Ah/5HR)



Specification

Voltage Per Unit	2V(single cell)
Capacity	825Ah@5hr-rate to 1.70V per cell @25°C
Weight	Approx. without electrolyte 37.7 Kg Approx. including electrolyte 47.6 Kg
High Rate Discharge Current	825 A
Operating Temperature Range	Discharge: -40°C~60°C Charge: -20°C~50°C Storage: -40°C~60°C
Optimal Operating Temperature Range	25°C ± 5°C
Maximum Charging Current	123.8 A
Cycle charged	2.65 to 2.85 VDC/unit Average at 25°C
Self Discharge	Self-discharge ratio less than 5% per month at 25°C. Please charge batteries before using.
Terminal	D2(M10 Copper Terminals) & D4(Lead Terminals)
Dimensions (L×W×H×TH)	189mm×158mm×511mm×541mm(Total High)

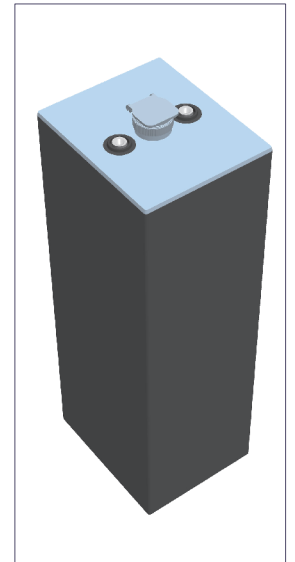

Constant Current Discharge Characteristics : A(25°C)

F.V/Time	30MIN	1HR	2HR	3HR	4HR	5HR	6HR	8HR	10HR
1.60V	781.5	547.2	317.0	237.4	193.7	173.7	150.6	117.3	96.9
1.65V	763.6	534.7	309.8	232.0	189.3	169.8	147.1	114.6	94.6
1.70V	742.2	519.8	301.1	225.5	184.0	165.0	143.0	111.4	92.0
1.75V	713.9	499.8	289.5	216.8	176.9	158.7	137.5	107.1	88.4
1.80V	681.5	477.3	276.5	207.1	168.9	151.5	131.3	102.3	84.5
1.85V	645.7	452.3	262.0	196.2	160.1	143.6	124.4	96.9	80.0

Constant Power Discharge Characteristics : W(25°C)

F.V/Time	30MIN	1HR	2HR	3HR	4HR	5HR	6HR	8HR	10HR
1.60V	1461.6	1053.9	622.8	470.9	384.8	345.4	299.4	233.4	192.9
1.65V	1435.4	1032.2	610.0	462.1	377.3	338.7	293.6	228.8	189.1
1.70V	1411.4	1004.8	593.8	450.6	367.6	330.0	286.0	222.8	184.0
1.75V	1358.5	966.5	571.2	433.3	353.5	317.3	275.0	214.2	176.9
1.80V	1298.3	927.9	548.4	413.8	337.9	303.0	262.6	204.5	168.9
1.85V	1237.3	886.0	523.6	392.5	320.2	287.2	248.9	193.8	160.1

Life characteristics of cyclic use

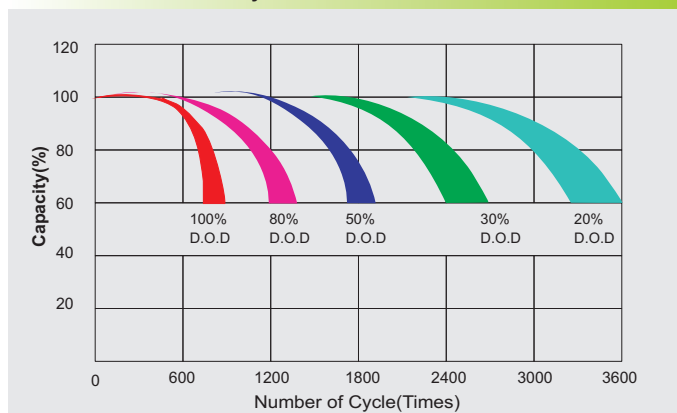

Charge characteristic Curve for cycle use

