

# 10PzS 600

(2V600Ah/5HR)



## Specification

Voltage Per Unit	2V(single cell)
Capacity	600Ah@5hr-rate to 1.70V per cell @25°C
Weight	Approx. without electrolyte 28.3 Kg Approx. including electrolyte 35.5 Kg
High Rate Discharge Current	600 A
Operating Temperature Range	Discharge: -40°C~60°C Charge: -20°C~50°C Storage: -40°C~60°C
Optimal Operating Temperature Range	25°C ± 5°C
Maximum Charging Current	90.0 A
Cycle charged	2.65 to 2.85 VDC/unit Average at 25°C
Self Discharge	Self-discharge ratio less than 5% per month at 25°C. Please charge batteries before using.
Terminal	D2(M10 Copper Terminals) & D4(Lead Terminals)
Dimensions (L×W×H×TH)	192mm×198mm×340mm×370mm(Total High)

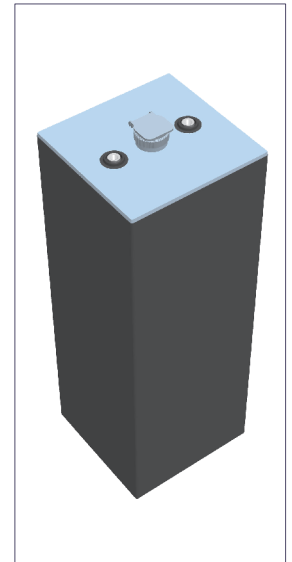

### Constant Current Discharge Characteristics : A(25°C)

F.V/Time	30MIN	1HR	2HR	3HR	4HR	5HR	6HR	8HR	10HR
1.60V	568.4	398.0	230.6	172.7	140.9	126.3	109.5	85.3	70.4
1.65V	555.4	388.9	225.3	168.7	137.7	123.5	107.0	83.3	68.8
1.70V	539.8	378.0	219.0	164.0	133.8	120.0	104.0	81.0	66.9
1.75V	519.2	363.5	210.6	157.7	128.7	115.4	100.0	77.9	64.3
1.80V	495.7	347.1	201.1	150.6	122.9	110.2	95.5	74.4	61.4
1.85V	469.6	328.9	190.6	142.7	116.4	104.4	90.5	70.5	58.2

### Constant Power Discharge Characteristics : W(25°C)

F.V/Time	30MIN	1HR	2HR	3HR	4HR	5HR	6HR	8HR	10HR
1.60V	1063.0	766.5	453.0	342.5	279.9	251.2	217.8	169.7	140.3
1.65V	1044.0	750.7	443.6	336.1	274.4	246.3	213.5	166.4	137.5
1.70V	1026.5	730.7	431.8	327.7	267.4	240.0	208.0	162.0	133.8
1.75V	988.0	702.9	415.4	315.1	257.1	230.8	200.0	155.8	128.7
1.80V	944.2	674.8	398.8	300.9	245.7	220.4	191.0	148.8	122.9
1.85V	899.8	644.3	380.8	285.4	232.9	208.8	181.0	141.0	116.4

### Life characteristics of cyclic use

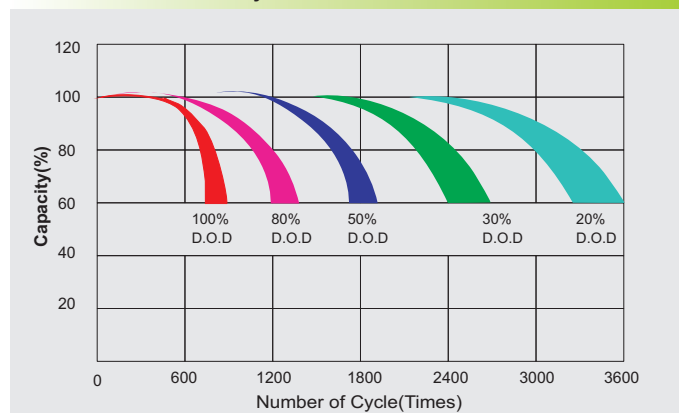

### Charge characteristic Curve for cycle use

