



# RA12-260 (12V260Ah)

RA12-260 is a general purpose battery with 10 years floating design life, meet with IEC, JIS .BS and Eurobat standard. With heavy duty grid, thickness plates, special additives, RA series battery have long and reliable standby service life. Our RA Series batteries keep high consistent for better performance in series usage.



## Specification

Cells Per Unit	6
Voltage Per Unit	12
Capacity	260Ah@10hr-rate to 1.80V per cell @25°C
Weight	Approx.74.0 Kg
Max. Discharge Current	2600A (5 sec)
Internal Resistance	Approx. 3.5 mΩ
Operating Temperature Range	Discharge: -20°C~60°C Charge: 0°C~50°C Storage: -20°C~60°C
Normal Operating Temperature Range	25°C±5°C
Float charging Voltage	13.6 to 13.8 VDC/unit Average at 25°C
Recommended Maximum Charging Current Limit	78 A
Equalization and Cycle Service	14.6 to 14.8 VDC/unit Average at 25°C
Self Discharge	RITAR Valve Regulated Lead Acid (VRLA) batteries can be stored for more than 6 months at 25°C. Self-discharge ratio less than 3% per month at 25°C. Please charge batteries before using.
Terminal	Terminal F14
Container Material	A.B.S. (UL94-HB), Flammability resistance of UL94-V1 can be available upon request.



MH28539



G4M20206-0910-E-16



ISO9001:2000 Certificate

## Dimensions

Unit: mm Dimension: 520(L)×268(W)×220(H)

Terminal F14

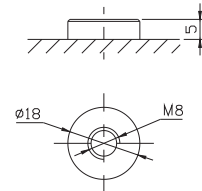
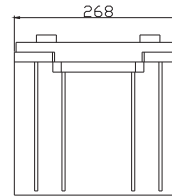
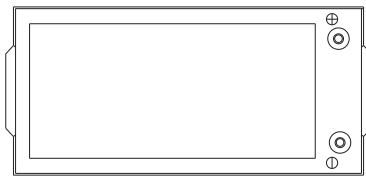
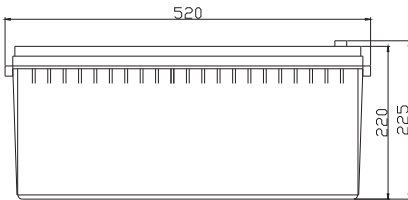

## Constant Current Discharge Characteristics: A (25°C)

F.V/Time	5MIN	10MIN	15MIN	30MIN	1HR	2HR	3HR	4HR	5HR	8HR	10HR	20HR
9.60V	708.65	530.83	448.09	292.93	169.00	101.12	69.896	57.283	46.887	32.297	27.308	15.019
10.0V	688.17	505.08	438.90	288.09	168.22	100.36	69.628	57.018	46.612	32.034	27.045	14.746
10.2V	667.77	487.26	432.01	285.54	166.66	99.60	69.092	56.753	46.336	31.771	26.783	14.473
10.5V	599.63	449.62	411.33	278.41	165.10	98.84	68.825	56.222	45.784	31.509	26.520	14.200
10.8V	541.22	410.01	379.16	266.18	161.20	97.070	66.950	54.896	44.957	30.984	26.257	13.927
11.1V	462.12	366.43	340.09	249.37	153.14	92.761	64.004	52.244	43.026	29.671	25.470	13.108

## Constant Power Discharge Characteristics: W(25°C)

F.V/Time	5MIN	10MIN	15MIN	30MIN	1HR	2HR	3HR	4HR	5HR	8HR	10HR	20HR
9.6V	7329.7	5653.4	4929.0	3339.4	1952.9	1191.9	831.76	682.82	559.37	385.62	326.33	180.08
10.0V	7185.3	5480.2	4849.9	3298.6	1948.2	1185.6	832.05	681.94	557.94	383.77	324.27	176.95
10.2V	7103.2	5335.5	4795.3	3275.2	1933.2	1178.5	828.42	680.47	556.03	381.26	321.39	173.68
10.5V	6466.6	4968.3	4574.0	3198.9	1915.8	1169.9	825.21	674.11	549.41	378.11	318.24	170.40
10.8V	5889.8	4579.8	4227.6	3066.4	1880.4	1155.0	802.73	658.76	539.48	371.81	315.09	167.12
11.1V	5173.3	4140.7	3805.6	2880.3	1799.9	1112.1	768.05	626.93	516.31	356.05	305.64	157.29

All mentioned values are average values.

### Effect of temperature on long term float life

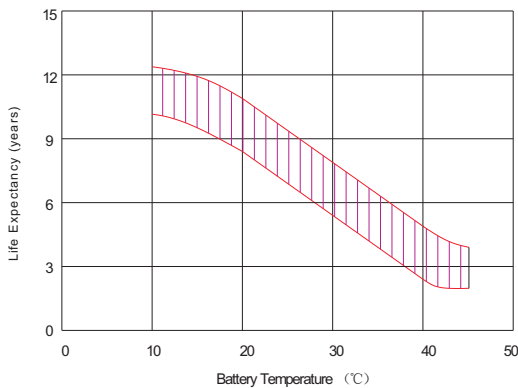

### Storage characteristic

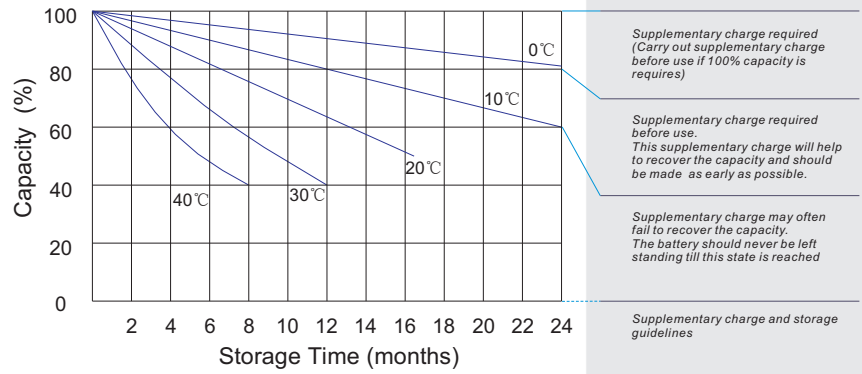

### Charge characteristic Curve for standby use

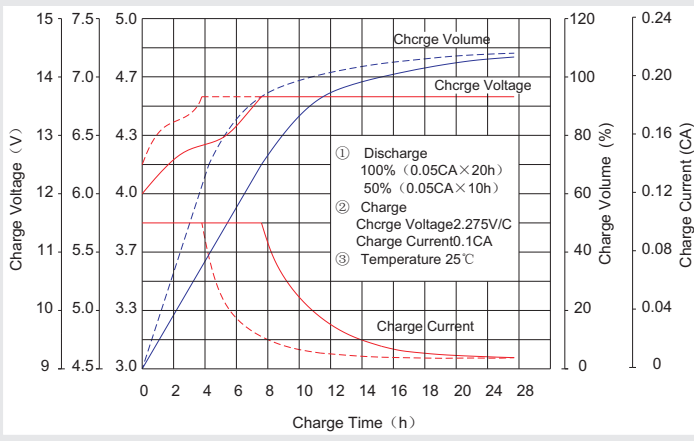

### Discharge characteristic Curve

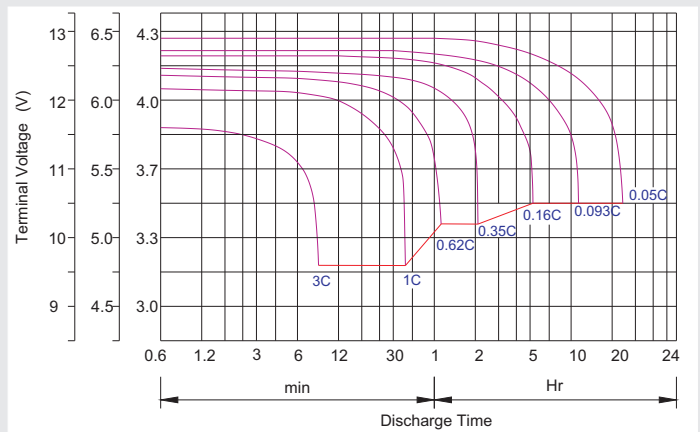

### Capacity Factors With Different Temperature

Battery Type		-20°C	-10°C	0°C	5°C	10°C	20°C	25°C	30°C	40°C	45°C
GEL Battery	6V&12V	50%	70%	83%	85%	90%	98%	100%	102%	104%	105%
	2V	60%	75%	85%	88%	92%	99%	100%	103%	105%	106%
AGM Battery	6V&12V	46%	66%	76%	83%	90%	98%	100%	103%	107%	109%
	2V	55%	70%	80%	85%	92%	99%	100%	104%	108%	110%

### Discharge Current VS. Discharge Voltage

Final Discharge Voltage V/cell	1.75V	1.70V	1.60V
Discharge Current (A)	(A) ≤ 0.2C	0.2C < (A) < 1.0C	(A) ≥ 1.0C

**Charge the batteries at least once every six months, if they are stored at 25°C.**

Charging Method:

Constant Voltage	-0.2Cx2h+2.4-2.45V/cellx24h, Max. Current 0.3CA
Constant Current	-0.2Cx2h+0.1CAx12h
Fast	-0.2Cx2h+0.3CAx4.0h

### Maintenance & Cautions

<b>Float Service:</b>
※ Every month, recommend inspection every battery voltage.
※ Every three months, recommend equalization charge for one time.
Equalization charge method:
Discharge: 100% rate capacity discharge.
Charge: Max. current 0.3CA, constant voltage 2.4-2.45V/Cell charge 24h.
※ Effect of temperature on float charge voltage: -3mV/°C/Cell.
※ Length of service life will be directly affected by the number of discharge cycles, depth of discharge, ambient temperature and charging voltage.